

132 133 147 134 135 136 137 138 139 140 141 142 143 144 145 146

KERA.BASE
JUNCTION 45°

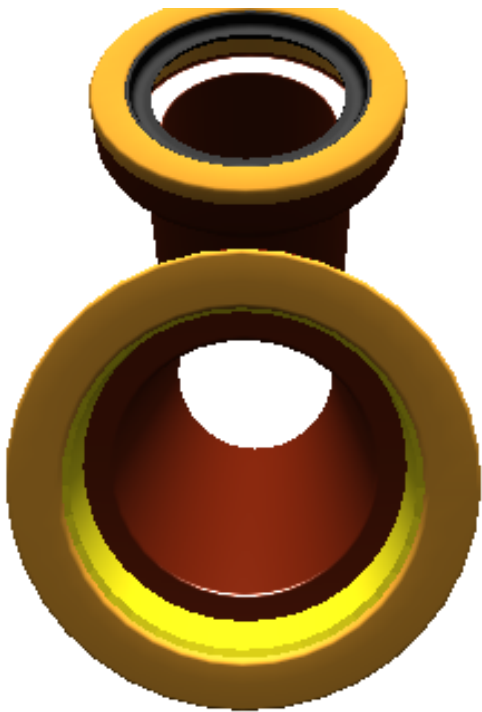

TECHNICAL DRAWING

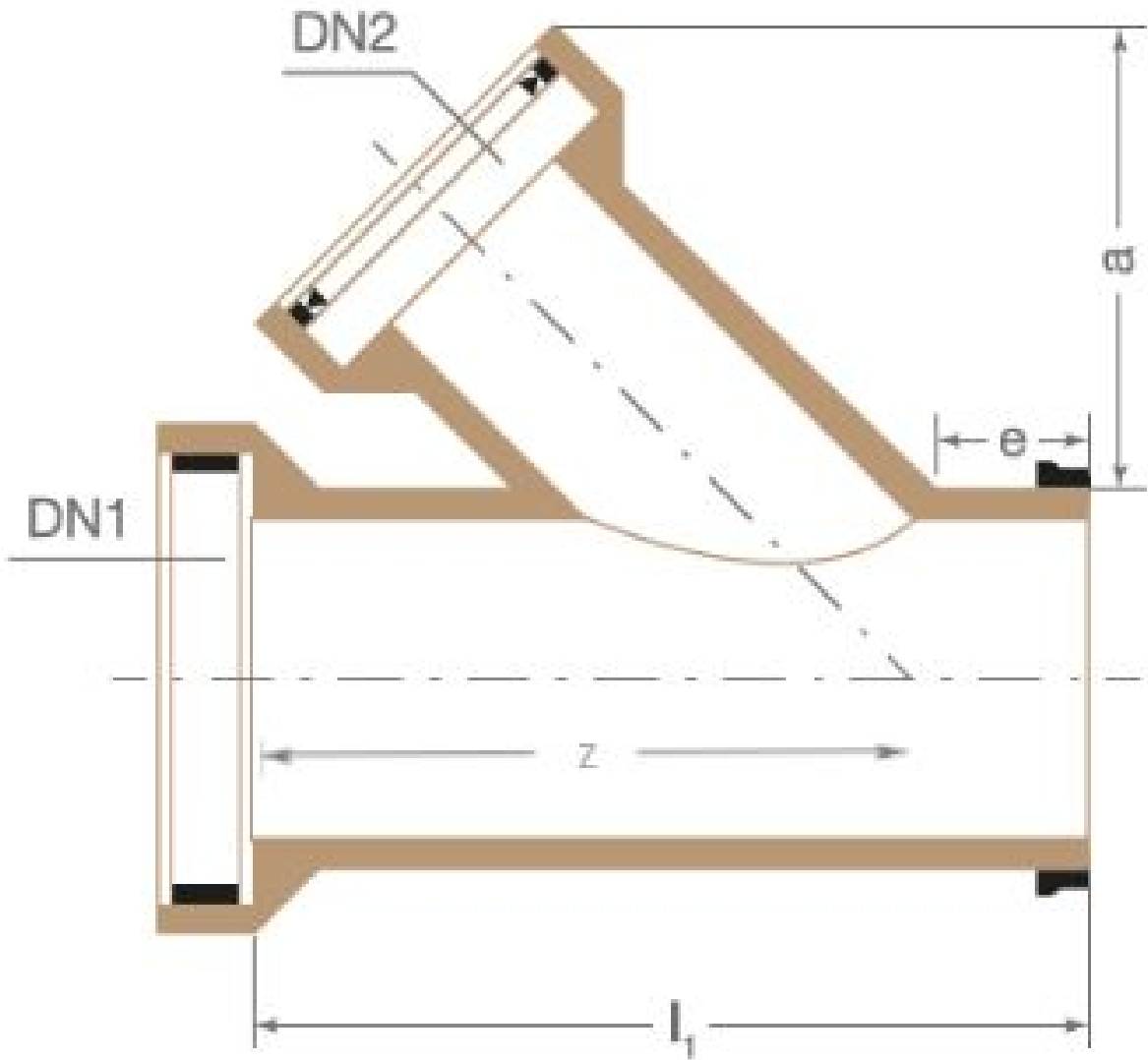

NOMINAL SIZE DN1 250

- 100
- 125
- 150
- 200
- 250
- 300

NOMINAL SIZES DN2

- 100
- 125
- 150
- 200

JOINT DN1/DN2

- KK
- LL
- KL

LENGTH (CM)

50

WEIGHT

TKL

41 kg/piece

160/34

MEASUREMENTS

| Nominal size | Branch size | Dimensions | | |
|--------------|-------------|--------------|--------------|--------------|
| DN 1 | DN 2 | z max. mm | e max. mm | a max. mm |
| 250 | 150 | 400 | 85 | 350 |

BRIEF DESCRIPTION

Angle ±5°

The dimensions z, a and e are reference values. Other dimensions and crushing strengths: see pipes. The strength class of the branch piece is always normal strength.

Vitrified clay pipes and fittings are standardised in EN 295-1. Supplementary requirements defines the certification program ZP WN 295. All measurements - especially when connecting to other products - must be checked and depend on the specifications of EN 295 and on the certification program ZP WN 295. Subject to technical changes.

